

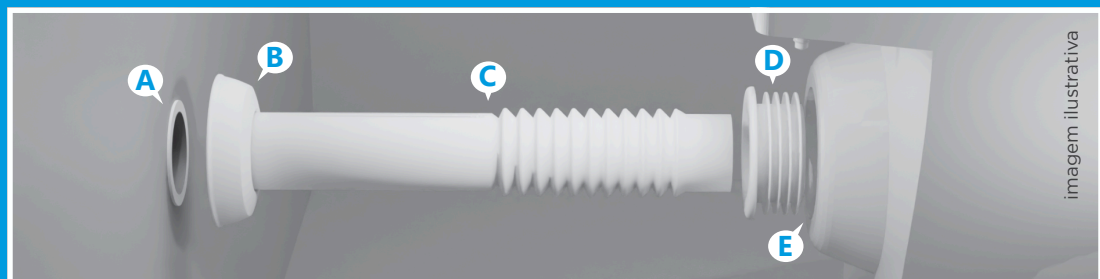

Tubo de ligação ajustável

LEGENDA



A
Conexão de saída da parede

B
Canopla

C
Tubo de ligação

D
Espude

E
Vaso Sanitário

INSTALAÇÃO

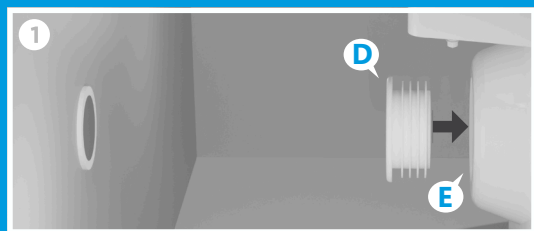

Passo 1: Coloque o espude (D) no vaso sanitário (E).

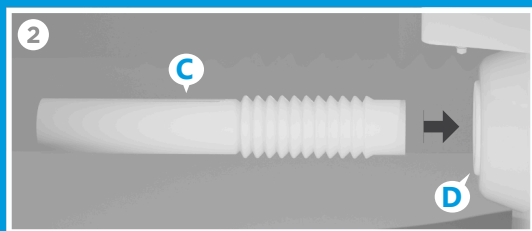

Passo 2: Conecte o tubo (C) no espude (D).

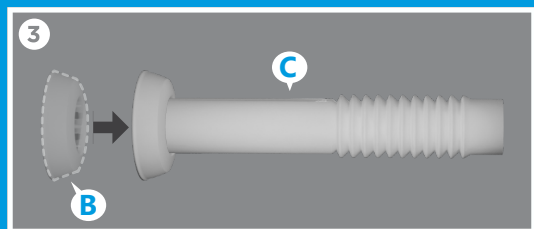

Passo 3: Coloque a canopla (B) no tubo de ligação (C).

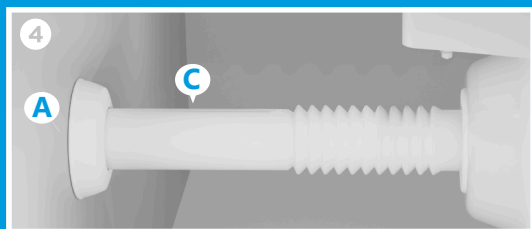

Passo 4: Conecte o outro lado do tubo (C) na parede (A).

OBSERVAÇÃO



Se necessário corte o tubo (C), para isso meça a distância entre o vaso (E) e a parede (A), deixando até 2 cm extras para o encaixe na parede (A).

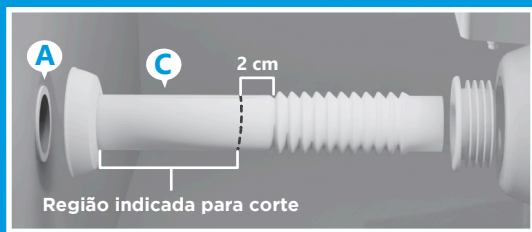

SAC 0800.1605051
www.astra-sa.com

ASTRA S/A IND. E COM. • CNPJ: 50.949.528/0001-80
R. Colégio Florence, 59 - Jd. Primavera - Jundiaí - SP
Otros países/Other countries:
+55 (11) 4583-7749/7736 • export@astra-sa.com
Fabricado no Brasil - Hecho en Brasil - Made in Brazil



Conjunto de conexiones para inodoros

LEYENDA

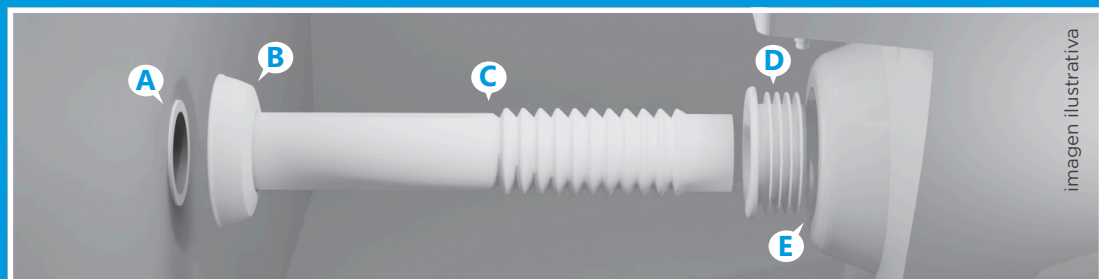

A
Conexión de salida de la pared

B
Escudo

C
Tubo de conexión

D
Spud

E
Inodoro

INSTALACIÓN

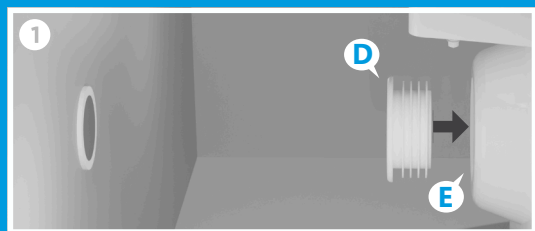

Paso 1: Coloque el spud (D) en el inodoro (E).

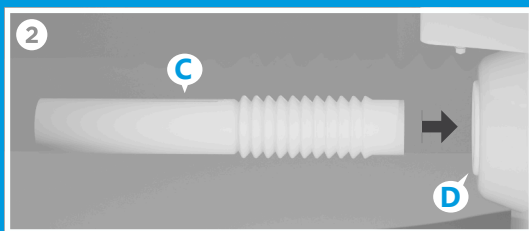

Paso 2: Conecte el tubo (C) al spud (D).

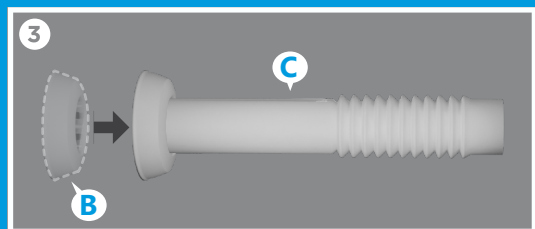

Paso 3: Coloque el escudo (B) en el tubo de conexión (C).

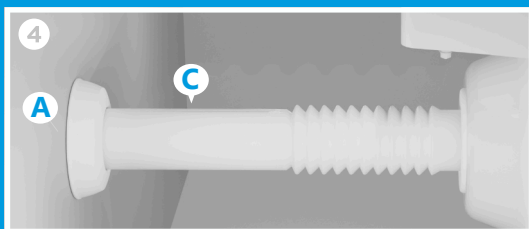

Paso 4: Conecte el otro extremo del tubo (C) a la pared (A).

OBSERVACIÓN



Si es necesario, corte el tubo (C). Mida la distancia entre el inodoro (E) y la pared (A), dejando hasta 2 cm adicionales para el encaje en la pared (A).



SAC 0800.1605051
www.astra-sa.com

ASTRA S/A IND. E COM. • CNPJ: 50.949.528/0001-80
R. Colégio Florence, 59 - Jd. Primavera - Jundiaí - SP
Otros países/Other countries:
+55 (11) 4583-7749/7736 • export@astra-sa.com
Fabricado no Brasil - Hecho en Brasil - Made in Brazil



Pipe for connecting sanitary bowl

CAPTION

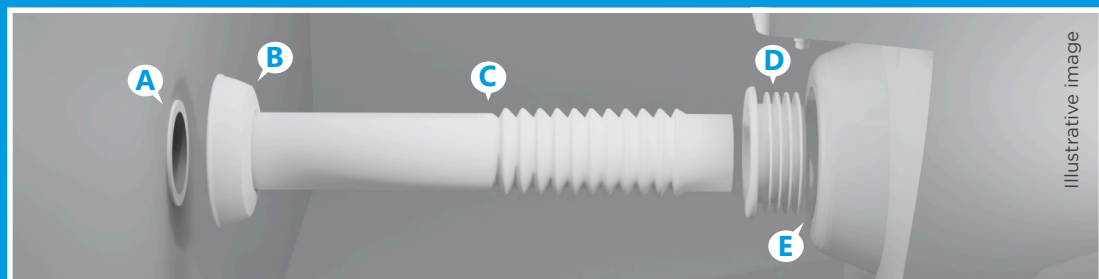

| | | | | |
|------------------------|------------|-----------------|----------|---------------|
| A | B | C | D | E |
| Wall outlet connection | Escutcheon | Connection pipe | Spud | Sanitary Bowl |

INSTALLATION

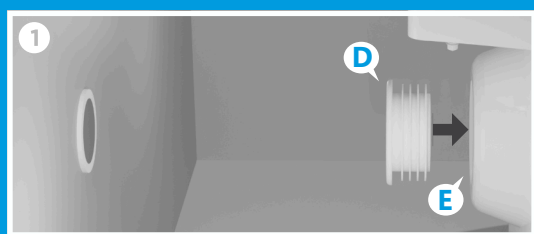

Step 1: Place the spud (D) on the Sanitary Bowl (E).

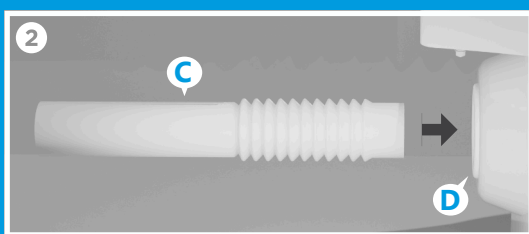

Step 2: Connect the pipe (C) to the spud (D).

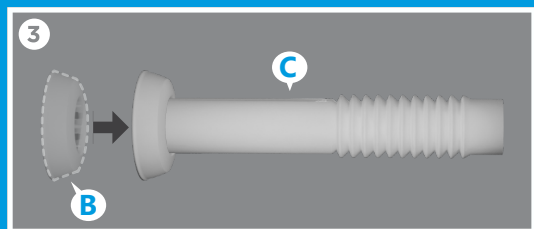

Step 3: Place the escutcheon (B) on the pipe (C).

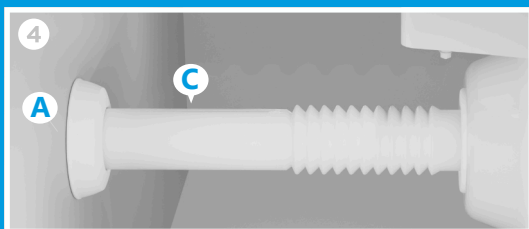

Step 4: Connect the other end of the pipe (C) to the wall (A).

NOTE



If necessary, cut the pipe (C). Measure the distance between the Sanitary Bowl (E) and the wall (A), leaving up to 2 cm extra for fitting into the wall (A).

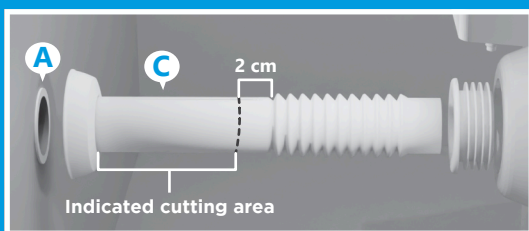

SAC 0800.1605051
www.astra-sa.com

ASTRA S/A IND. E COM. • CNPJ: 50.949.528/0001-80
R. Colégio Florence, 59 - Jd. Primavera - Jundiaí - SP
Otros países/Other countries:
+55 (11) 4583-7749/7736 • export@astra-sa.com
Fabricado no Brasil - Hecho en Brasil - Made in Brazil